

No.	Description
1	LED Mirror

Fixings Included
YES



Features

- LED Technology
- IR sensor
- IP44 Rated
- Heated demister pad
- Tapered Body

Dimensions

Diagrams not to scale. All dimensions in mm (tolerance of +/-5mm)

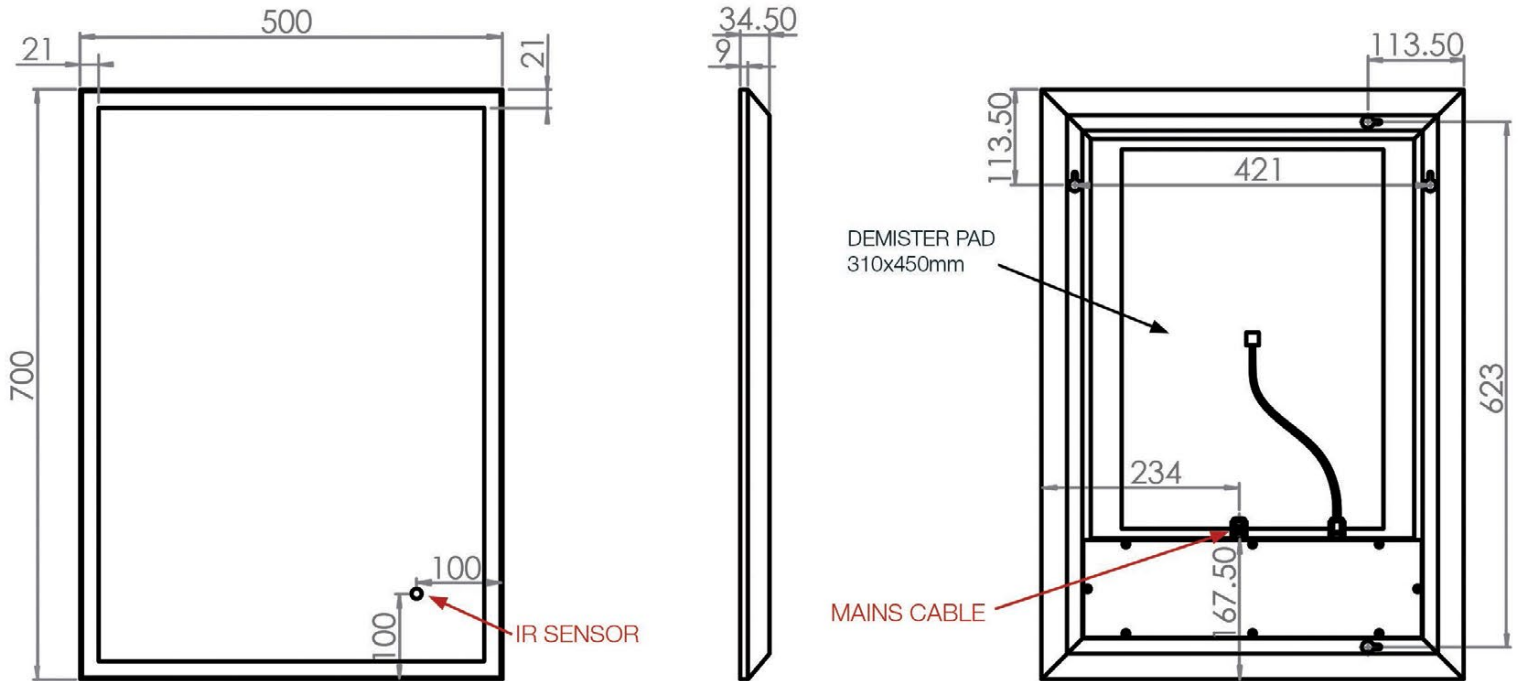

*Dimensions are subject to change, customers are advised to measure actual product before commencing installation.
**Fixing point dimensions are for guidance only/the positions of wall fixing must be checked when product is received.

FAQ's

Q: Is the mirror IP44 rated?

A: Yes, it can be placed in Zone 2 and outside zones.

Q: Can the mirror be hung portrait and landscape?

A: Yes.

Q: How do you fix the mirror to the wall?

A: The mirror is installed using the fixing pack provided. Refer to enclosed instructions for further details.

Q: What size fuse should I use?

A: We cannot recommend fuse size as each installation is different a qualified Electrician should be consulted in accordance with IEE 7671.

Q: What is the thickness of the mirror glass?

A: 5mm PVC back filmed.

FAQ's

Q: Is the mirror fitted with a mains cable?

A: Yes, the cable length is approximately 500mm (see drawing above). There is plenty of room for excess cable if needed.

Q: What is the total power consumption?

A: 44 Watts.

Q: Does the mirror/cabinet have an energy rating?

A: The mirror has an energy rating for the LED lighting used only in accordance with EU 874-2012. LED's used in this products are rated as 'A'.

Q: What is the wattage of the lights?

A: 17 Watts.

Q: What is the color of the light?

A: 6500K (cool white)

Q: Does the mirror/cabinet have a shaver socket?

A: No

Q: What is the output of the demister pad?

A: 27 Watts.

Q: What size is the demister pad?

A: size: 310x450mm.

Q: How do I turn on the demister pad?

A: The demister pad is activated when the light on the mirror is 'ON'.

Q: Where is the IR sensor located?

A: See previous page drawings.

Q: Can the IR sensor be re-positioned?

A: No, the location of the IR sensor can't be changed.

Q: Can the LED lighting or IR sensor be replaced?

A: Yes, See on last page instruction packages available for this mirror.

Q: What is the guarantee on this product?

A: 2 years