

## BLOQUE 1300MM X 700MM SINGLE ENDED BATH (INC LEG PACK 1)

Category: baths  
 Guarantee: 25 year  
 Type: Single Ended  
 Weight: 25.00

Code: PBBQSE13X7  
 Range: BLOQUE  
 Volume: 0.13

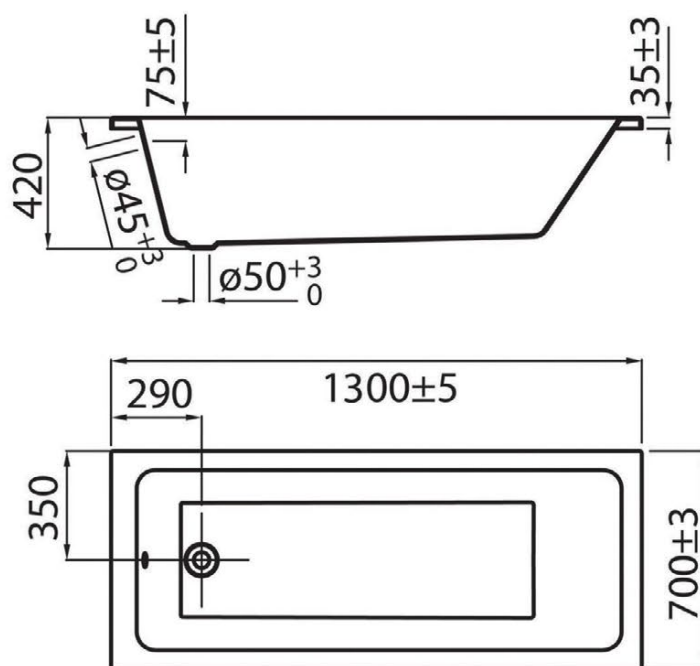

Dimensions are in millimetres except thread sizes which are BSP imperial.

### Features

- Excludes wastes, taps
- Includes leg pack
- 122 litre capacity

### Notes

Our guarantee is subject to the product having been installed, used and maintained in accordance with our instructions. All working parts (such as hinges, ceramic disks, cartridges, seals and cistern fittings), which are subject to normal wear and tear, are covered for 36 months from proof of purchase date. This excludes seats, which are covered for 12 months. Our guarantee applies to the original purchaser and is nontransferable. Our guarantee is only applicable in the UK and ROI. This does not affect your statutory rights.

We recommend that a pressure reducing valve is fitted in installations where the water supply pressure exceeds 3 bar. Pressure in excess of 3 bar could reduce the working life of this product and invalidate the guarantee.

Information is provided for guidance only and is non-binding. All measurements are approximate and subject to standard tolerances. We reserve the right to change product specifications without prior notification.

## BLOQUE 1400MM X 700MM SINGLE ENDED BATH (INC LEG PACK 1)

Category:	baths	Code:	PBBQSE14X7
Guarantee:	25 year	Range:	BLOQUE
Type:	Single Ended	Volume:	0.13
Weight:	26.00		

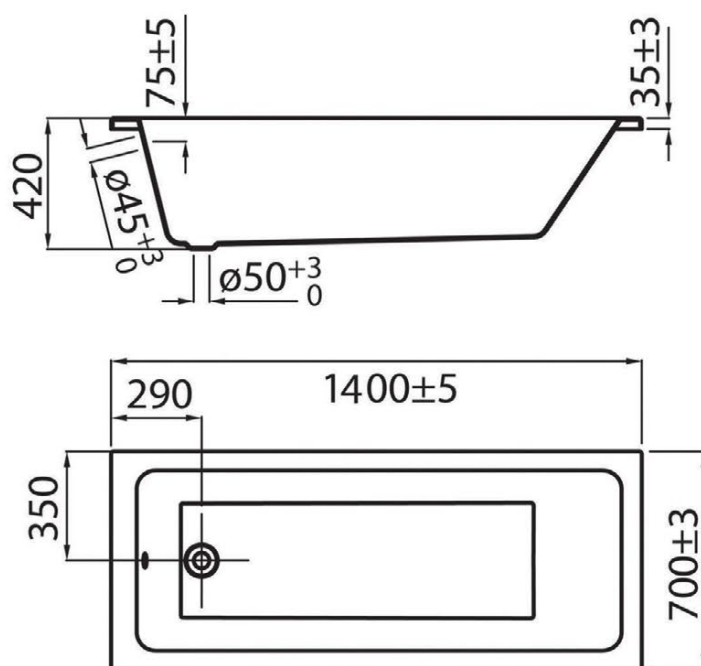

Dimensions are in millimetres except thread sizes which are BSP imperial.

### Features

- Excludes wastes, taps
- Includes leg pack
- 130 litre capacity

### Notes

Our guarantee is subject to the product having been installed, used and maintained in accordance with our instructions. All working parts (such as hinges, ceramic disks, cartridges, seals and cistern fittings), which are subject to normal wear and tear, are covered for 36 months from proof of purchase date. This excludes seats, which are covered for 12 months. Our guarantee applies to the original purchaser and is nontransferable. Our guarantee is only applicable in the UK and ROI. This does not affect your statutory rights.

We recommend that a pressure reducing valve is fitted in installations where the water supply pressure exceeds 3 bar. Pressure in excess of 3 bar could reduce the working life of this product and invalidate the guarantee.

Information is provided for guidance only and is non-binding. All measurements are approximate and subject to standard tolerances. We reserve the right to change product specifications without prior notification.

## BLOQUE 1500MM X 700MM SINGLE ENDED BATH (INC LEG PACK 1)

Category:	baths	Code:	PBBQSE15X7
Guarantee:	25 year	Range:	BLOQUE
Type:	single ended	Volume:	0.14
Weight:	28.00		

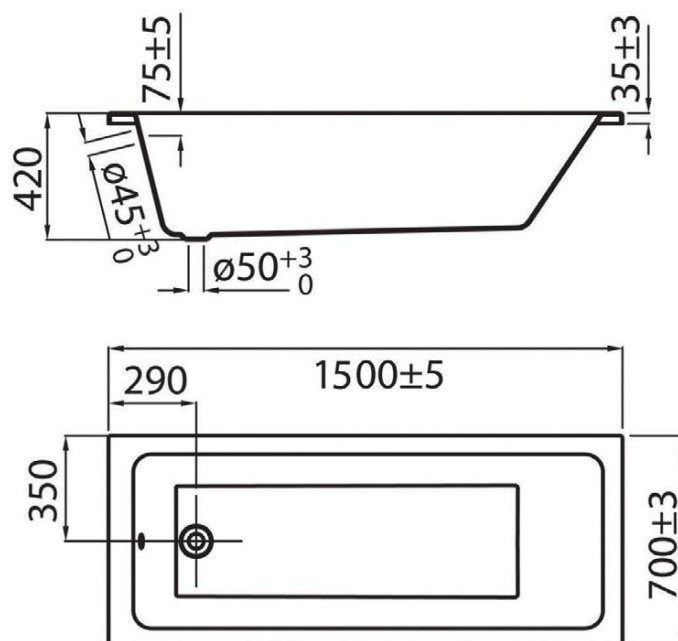

Dimensions are in millimetres except thread sizes which are BSP imperial.

### Features

- Excludes wastes, taps
- Includes leg pack
- 140 litre capacity

### Notes

Our guarantee is subject to the product having been installed, used and maintained in accordance with our instructions. All working parts (such as hinges, ceramic disks, cartridges, seals and cistern fittings), which are subject to normal wear and tear, are covered for 36 months from proof of purchase date. This excludes seats, which are covered for 12 months. Our guarantee applies to the original purchaser and is nontransferable. Our guarantee is only applicable in the UK and ROI. This does not affect your statutory rights.

We recommend that a pressure reducing valve is fitted in installations where the water supply pressure exceeds 3 bar. Pressure in excess of 3 bar could reduce the working life of this product and invalidate the guarantee.

Information is provided for guidance only and is non-binding. All measurements are approximate and subject to standard tolerances. We reserve the right to change product specifications without prior notification.



## BLOQUE 1600MM X 700MM SINGLE ENDED BATH (INC LEG PACK 1)

Category:	baths	Code:	PBBQSE16X7
Guarantee:	25 year	Range:	BLOQUE
Type:	single ended	Volume:	0.15
Weight:	29.00		

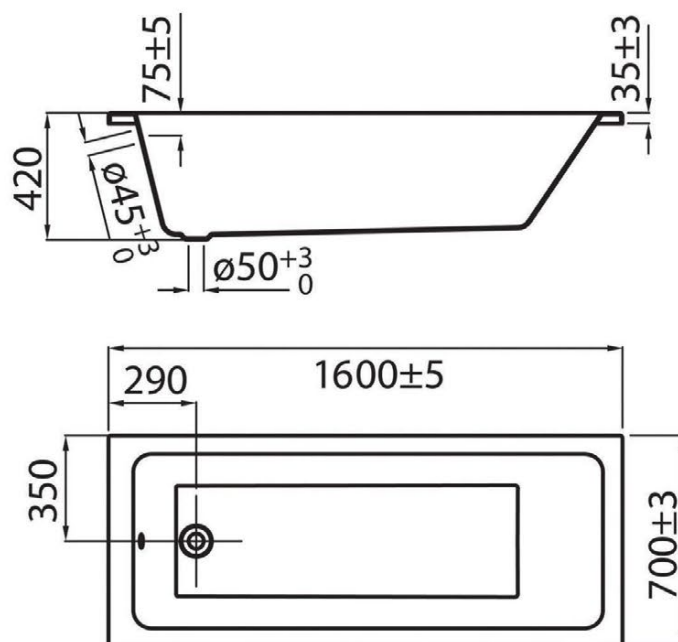

Dimensions are in millimetres except thread sizes which are BSP imperial.

### Features

- Excludes wastes, taps
- Includes leg pack
- 150 litre capacity

### Notes

Our guarantee is subject to the product having been installed, used and maintained in accordance with our instructions. All working parts (such as hinges, ceramic disks, cartridges, seals and cistern fittings), which are subject to normal wear and tear, are covered for 36 months from proof of purchase date. This excludes seats, which are covered for 12 months. Our guarantee applies to the original purchaser and is nontransferable. Our guarantee is only applicable in the UK and ROI. This does not affect your statutory rights.

We recommend that a pressure reducing valve is fitted in installations where the water supply pressure exceeds 3 bar. Pressure in excess of 3 bar could reduce the working life of this product and invalidate the guarantee.

Information is provided for guidance only and is non-binding. All measurements are approximate and subject to standard tolerances. We reserve the right to change product specifications without prior notification.

## BLOQUE 1700MM X 700MM SINGLE ENDED BATH (INC LEG PACK 1)

Category:	baths	Code:	PBBQSE17X7
Guarantee:	25 year	Range:	BLOQUE
Type:	single ended	Volume:	0.15
Weight:	31.00		

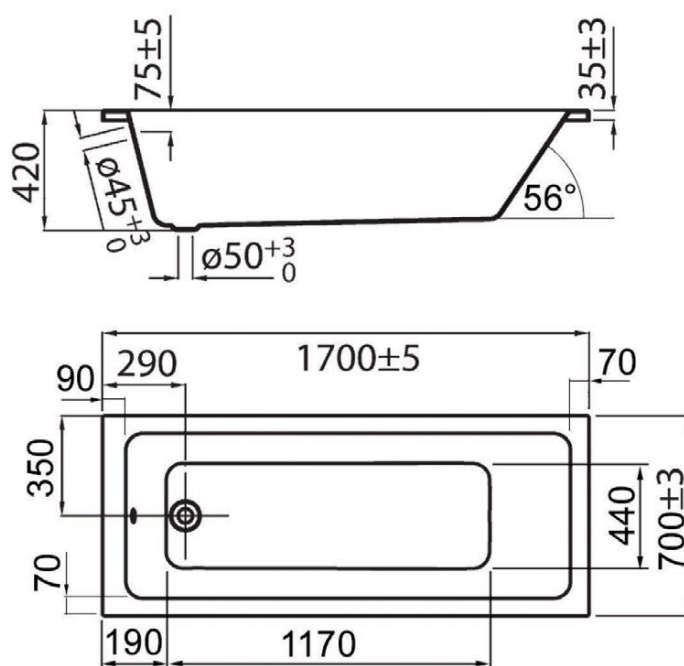

Dimensions are in millimetres except thread sizes which are BSP imperial.

### Features

- Excludes wastes, taps
- Includes leg pack
- 160 litre capacity

### Notes

Our guarantee is subject to the product having been installed, used and maintained in accordance with our instructions. All working parts (such as hinges, ceramic disks, cartridges, seals and cistern fittings), which are subject to normal wear and tear, are covered for 36 months from proof of purchase date. This excludes seats, which are covered for 12 months. Our guarantee applies to the original purchaser and is nontransferable. Our guarantee is only applicable in the UK and ROI. This does not affect your statutory rights.

We recommend that a pressure reducing valve is fitted in installations where the water supply pressure exceeds 3 bar. Pressure in excess of 3 bar could reduce the working life of this product and invalidate the guarantee.

Information is provided for guidance only and is non-binding. All measurements are approximate and subject to standard tolerances. We reserve the right to change product specifications without prior notification.

## BLOQUE 1700MM X 750MM DOUBLE ENDED BATH (INC LEG PACK 1)

Category:	baths	Code:	PBBQDE17X75
Guarantee:	25 year	Range:	bloque
Type:	double ended	Volume:	0.12
Weight:	34.00		

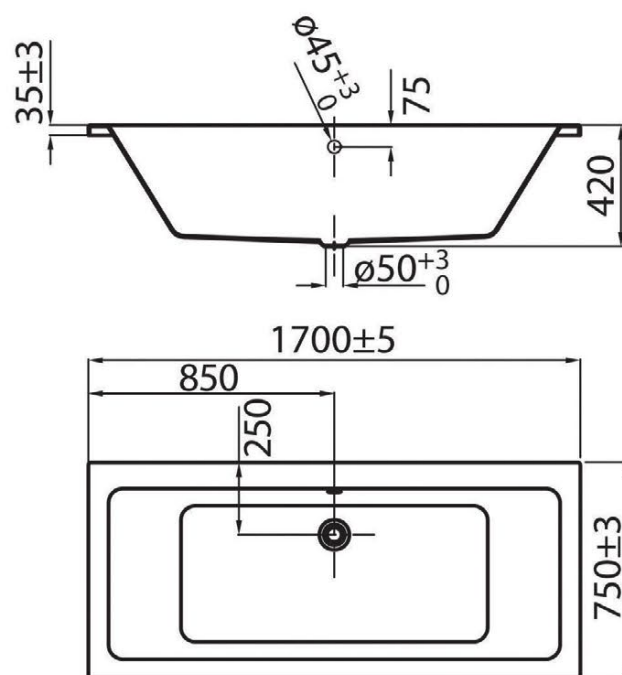

Dimensions are in millimetres except thread sizes which are BSP imperial.

### Features

- Excludes wastes, taps
- Includes leg pack
- 180 litre capacity

### Notes

Our guarantee is subject to the product having been installed, used and maintained in accordance with our instructions. All working parts (such as hinges, ceramic disks, cartridges, seals and cistern fittings), which are subject to normal wear and tear, are covered for 36 months from proof of purchase date. This excludes seats, which are covered for 12 months. Our guarantee applies to the original purchaser and is nontransferable. Our guarantee is only applicable in the UK and ROI. This does not affect your statutory rights.

We recommend that a pressure reducing valve is fitted in installations where the water supply pressure exceeds 3 bar. Pressure in excess of 3 bar could reduce the working life of this product and invalidate the guarantee.

Information is provided for guidance only and is non-binding. All measurements are approximate and subject to standard tolerances. We reserve the right to change product specifications without prior notification.

## BLOQUE 1800MM X 800MM DOUBLE ENDED BATH (INC LEG PACK 2)

Category: baths  
 Guarantee: 25 year  
 Type: double ended  
 Weight: 39.00

Code:  
 Range:  
 Volume:

PBBQDE18X80  
 bloque  
 0.17

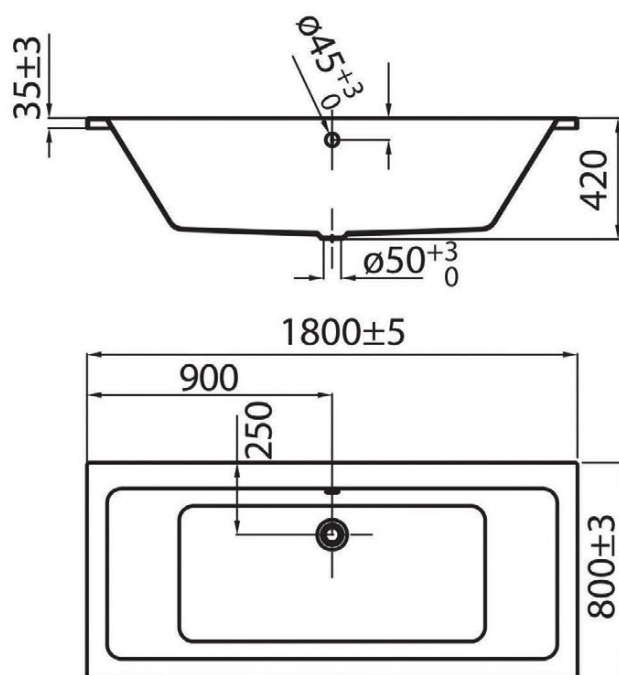

Dimensions are in millimetres except thread sizes which are BSP imperial.

### Features

- Excludes wastes, taps
- Includes leg pack
- 210 litre capacity

### Notes

Our guarantee is subject to the product having been installed, used and maintained in accordance with our instructions. All working parts (such as hinges, ceramic disks, cartridges, seals and cistern fittings), which are subject to normal wear and tear, are covered for 36 months from proof of purchase date. This excludes seats, which are covered for 12 months. Our guarantee applies to the original purchaser and is nontransferable. Our guarantee is only applicable in the UK and ROI. This does not affect your statutory rights.

We recommend that a pressure reducing valve is fitted in installations where the water supply pressure exceeds 3 bar. Pressure in excess of 3 bar could reduce the working life of this product and invalidate the guarantee.

Information is provided for guidance only and is non-binding. All measurements are approximate and subject to standard tolerances. We reserve the right to change product specifications without prior notification.