

**TECHNICAL DATA SHEET**  
**1700 X 750 LEFT HAND TAP HOLE BATH (LH)**

Category:  
Guarantee:  
Type:  
Weight:

Baths  
25 year  
single ended  
21.50

Volume:

0.16

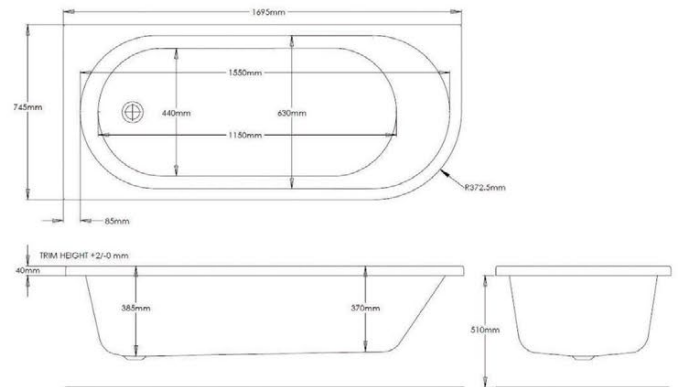

Dimensions are in millimetres except thread sizes which are BSP imperial.

**Features**

- Excludes wastes, taps
- Includes leg pack
- 200 litre capacity

**Notes**

Our guarantee is subject to the product having been installed, used and maintained in accordance with our instructions. All working parts (such as hinges, ceramic disks, cartridges, seals and cistern fittings), which are subject to normal wear and tear, are covered for 36 months from proof of purchase date. This excludes seats, which are covered for 12 months. Our guarantee applies to the original purchaser and is nontransferable. Our guarantee is only applicable in the UK and ROI. This does not affect your statutory rights.

We recommend that a pressure reducing valve is fitted in installations where the water supply pressure exceeds 3 bar. Pressure in excess of 3 bar could reduce the working life of this product and invalidate the guarantee.

**TECHNICAL DATA SHEET**  
**1700 X 750 RIGHT HAND TAP HOLE BATH (RH)**

|            |              |         |      |
|------------|--------------|---------|------|
| Category:  | Baths        | Volume: | 0.16 |
| Guarantee: | 25 year      |         |      |
| Type:      | single ended |         |      |
| Weight:    | 21.50        |         |      |

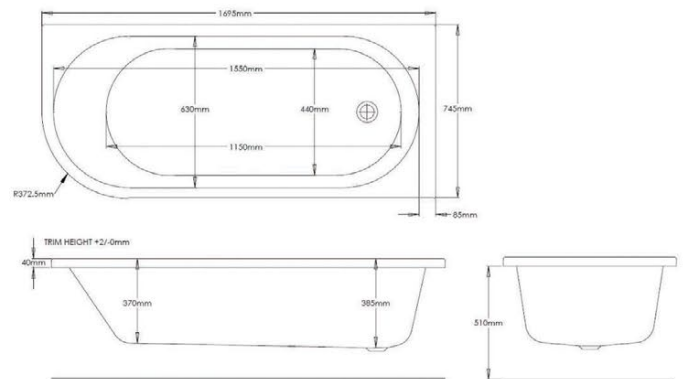

Dimensions are in millimetres except thread sizes which are BSP imperial.

**Features**

- Excludes wastes, taps
- Includes leg pack
- 200 litre capacity

**Notes**

Our guarantee is subject to the product having been installed, used and maintained in accordance with our instructions. All working parts (such as hinges, ceramic disks, cartridges, seals and cistern fittings), which are subject to normal wear and tear, are covered for 36 months from proof of purchase date. This excludes seats, which are covered for 12 months. Our guarantee applies to the original purchaser and is nontransferable. Our guarantee is only applicable in the UK and ROI. This does not affect your statutory rights.

We recommend that a pressure reducing valve is fitted in installations where the water supply pressure exceeds 3 bar. Pressure in excess of 3 bar could reduce the working life of this product and invalidate the guarantee.